

MASTECH® MS6520B

Infrared Thermometer

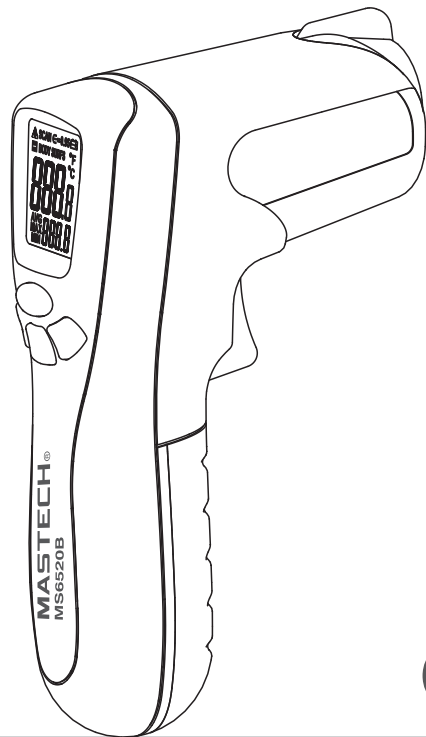

MASTECH®

Description

Noncontact Thermometer detects the infrared ray that an object emits, The instrument foculizes infrared energy of the object onto a sensor through a lens, changes the surface temperature into electric signal, a microcomputer calculates and displays the measurement temperature on the LCD.

- Single-spot Laser Sighting
- Backlit Display
- Current Temperature Plus MIN, MAX, AVG Temperature Displays
- Preset Emissivity 0.95

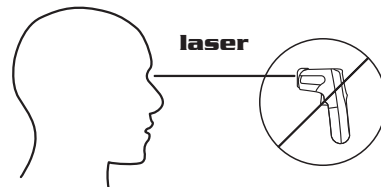

Warning

- Please read the following information carefully before using the meter.
- Do not clear the meter using solvents.
- Keep the instrument clean, and do not get dust into detecting hole.
- Do not point laser directly at eye or indirectly off reflective surfaces.
- Laser :class 2 <1mW/630-670nm

01

MASTECH®

Panel

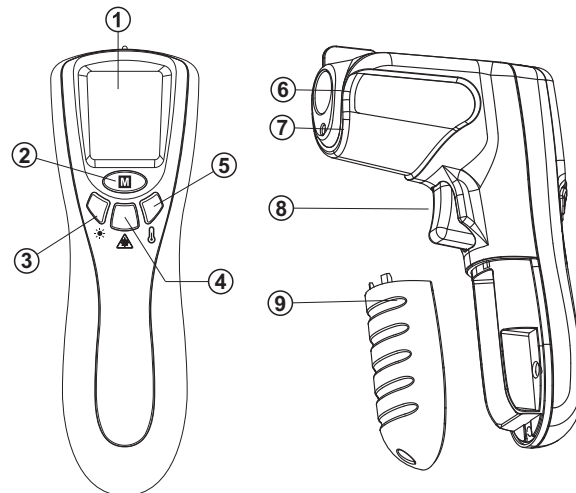

- | | |
|-----------------|-------------|
| ① Screen | ② Mode key |
| ③ Backlight key | ④ Laser key |
| ⑤ °C/°F key | ⑥ Sensor |
| ⑦ Laser | ⑧ Trigger |
| ⑨ Battery cover | |

02

MASTECH®

Display

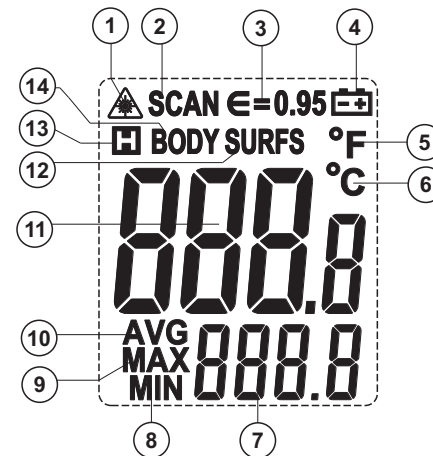

- | | | |
|---------------------|-----------------|--------------|
| ① Laser indicator | ② Scan status | ③ Emissivity |
| ④ Low battery | ⑤ °F unit | ⑥ °C unit |
| ⑦ Secondary display | ⑧ Min value | |
| ⑨ Max value | ⑩ Average value | |
| ⑪ Primary display | ⑫ Surface scan | |
| ⑬ Hold status | | |

03

MASTECH®

D:5 ratio

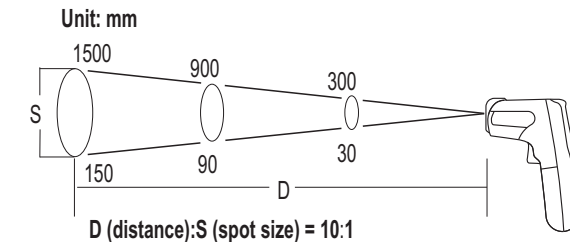

Make sure that the target is larger than the meter's visual spot size. The smaller the target, the closer you should be to it. The relationship between distance and spot size is 10:1

04

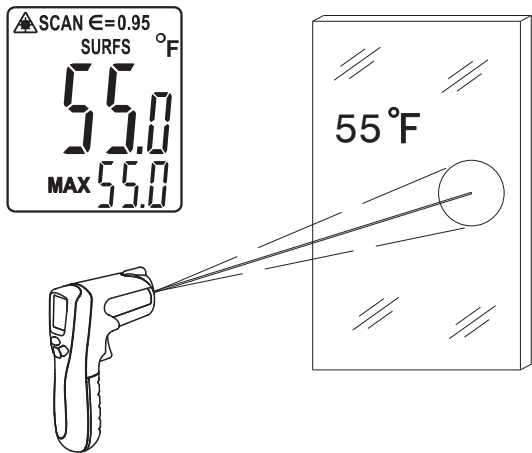

Operating Thermometer

- To measure temperature, pull and hold trigger. Release the trigger to hold a temperature reading. The meter turns off when no activity is detected for ten seconds.
- Press **M** key to toggle between the MAX ,MIN, AVG value.
- Press **LA** key to Active the laser.
- Press **☼** key to light on or off the backlight.
- Press **°C/°F** key to switch between °C or °F.

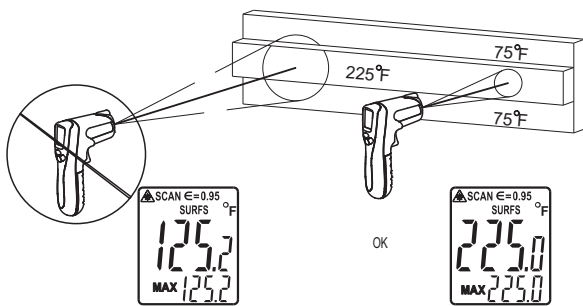

Note1

Make sure that the target is larger than the meter's visual spot size

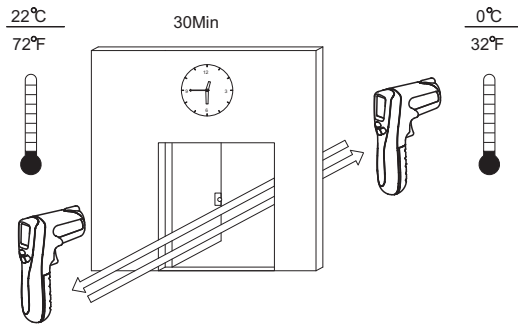

Note2

When ambient temperature changes quickly, must wait 30 minutes to balance the temperature of the instrument before use.

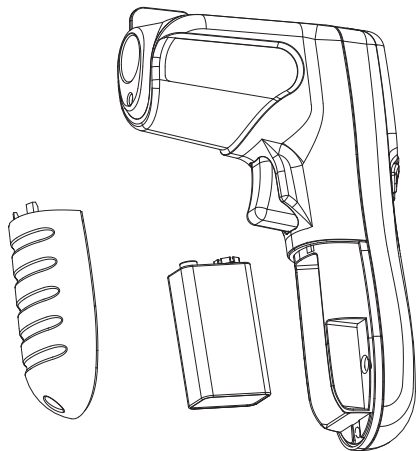

Note3

When the battery voltage is lower, the battery symbol appears, it indicates that we must change the battery.

Specifications

Temperature range	-20°C~500°C or -4°F~932°F	Certifications	CE
Accuracy: Assumes ambient	-20°C~0°C(±3°C)	Laser	<1mW /630-670nm class2
Operating temperature (23°C ± 2°C)	0°C~500°C (±1.5%rdg+2°C)		
Optical resolution	10:1	Spectral response	8-14 um
Repeatability	1°C	Response time	Approx.1s
Resolution	0.1°C/0.2°F	Emissivity	0.95
Ambient Operating Range	0~40°C	Dimensions	142×92×47mm
Relative humidity	10%~90%	Weight	135g
Standards	Conforms to: EN61326 EN61010-1 EN60825	Power	9V 6F22

Warranty

This produt will be free from defects in material and workmanship for eighteen months from the date of purchase.this warranty does not cover disposable batteries or damage for accident,neglect,misuse alteration conntamination,or abnormal conditions of operation ro handling.

